

## Cable to Reinforcing Steel

### Mold Information:

- Molds listed are for stranded cable. For solid conductor, add suffix "S" after conductor number. i.e. 4S = 4 AWG solid conductor.
- Price Key is the **Bold Letter** in the Mold Part No.

### Required Tools & Accessories:

- WRPSLV or CERPM - Packing Material
- CSH1 - Chain Support Handle clamp for "B" & "K" Price Key Molds

### OR

- MH1 - Handle for "B" and "K" Price Key Molds
- \*\*CSKIT - Chain Support Kit for #7 & Larger reinforcing steel

### Recommended Tools & Accessories:

- CCBRSH1 - Cable Cleaning Brush
- MCBRSH1 - Mold Cleaning Brush

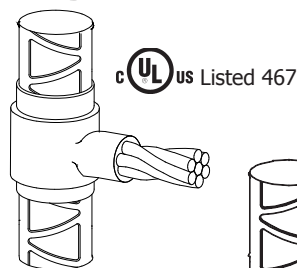

# RE

(Tee of Vertical Thru Reinforcing Steel & Horizontal Tap Cable)

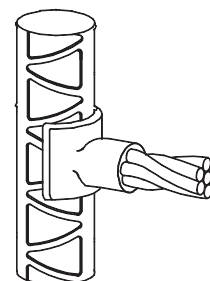

RE 7 & Larger

### RE Connection Type

Size	Cable Size	Mold Part No.	Packing Mat'l No.	Weld Metal	
				UltraShot	NUWTUBE
3	#6	RE-36B	WRPSLV	US45	NUWTUBE45
	#4	RE-34B	WRPSLV	US65	NUWTUBE65
	#2 Sol	RE-32SB	WRPSLV	US65	NUWTUBE65
	#2	RE-32B	WRPSLV	US65	NUWTUBE65
	1/0	RE-31/0B	WRPSLV	US115	NUWTUBE115
	2/0	RE-32/0B	WRPSLV	US115	NUWTUBE115
	3/0	RE-33/0B	WRPSLV	US150	NUWTUBE150
	4/0	RE-34/0B	WRPSLV	US150	NUWTUBE150
4	#6	RE-46B	WRPSLV	US45	NUWTUBE45
	#4	RE-44B	WRPSLV	US65	NUWTUBE65
	#2 Sol	RE-42SB	WRPSLV	US65	NUWTUBE65
	#2	RE-42B	WRPSLV	US65	NUWTUBE65
	1/0	RE-41/0B	WRPSLV	US115	NUWTUBE115
	2/0	RE-42/0B	WRPSLV	US115	NUWTUBE115
	3/0	RE-43/0B	WRPSLV	US150	NUWTUBE150
	4/0	RE-44/0B	WRPSLV	US150	NUWTUBE150
5	#6	RE-56B	WRPSLV	US45	NUWTUBE45
	#4	RE-54B	WRPSLV	US65	NUWTUBE65
	#2 Sol	RE-52SB	WRPSLV	US65	NUWTUBE65
	#2	RE-52B	WRPSLV	US65	NUWTUBE65
	1/0	RE-51/0B	WRPSLV	US115	NUWTUBE115
	2/0	RE-52/0B	WRPSLV	US115	NUWTUBE115
	3/0	RE-53/0B	WRPSLV	US150	NUWTUBE150
	4/0	RE-54/0B	WRPSLV	US150	NUWTUBE150
6	#6	RE-66B	WRPSLV	US45	NUWTUBE45
	#4	RE-64B	WRPSLV	US65	NUWTUBE65
	#2 Sol	RE-62SB	WRPSLV	US65	NUWTUBE65
	#2	RE-62B	WRPSLV	US65	NUWTUBE65
	1/0	RE-61/0B	WRPSLV	US115	NUWTUBE115
	2/0	RE-62/0B	WRPSLV	US115	NUWTUBE115
	3/0	RE-63/0B	WRPSLV	US150	NUWTUBE150
	4/0	RE-64/0B	WRPSLV	US150	NUWTUBE150
7** & Larger	#6	RE-7L6K	CERPM3	US45	NUWTUBE45
	#4	RE-7L4K	CERPM3	US65	NUWTUBE65
	#2 Sol	RE-7L2SK	CERPM3	US65	NUWTUBE65
	#2	RE-7L2K	CERPM3	US65	NUWTUBE65
	1/0	RE-7L1/0K	CERPM3	US115	NUWTUBE115
	2/0	RE-7L2/0K	CERPM3	US115	NUWTUBE115
	3/0	RE-7L3/0K	CERPM3	US150	NUWTUBE150
	4/0	RE-7L4/0K	CERPM3	US150	NUWTUBE150

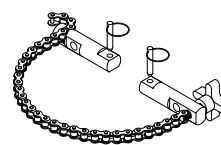

CSKIT

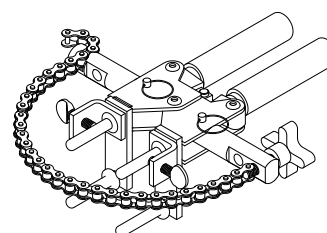

CSH1

Patented

**Important: See Packing Material Notes On Page 295.**

\*\*Requires #CSKIT Chain Support Kit for welds made to #7 and Larger reinforcing steel.

- (1) #WRPSLV Wrap Sleeve required per weld.
- (2) #CERPM3 Ceramic Packing Material required per weld.